

Product Information

FITUMBLESMIN - Mini Tumble Ball Insert

BS EN 1176 - Designed to British & European Standards

MATERIALS

Panel - Two Colour High Density Polyethylene (HDPE)

SUPPLY METHOD

Insert - Fully assembled

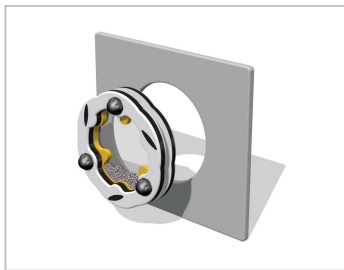
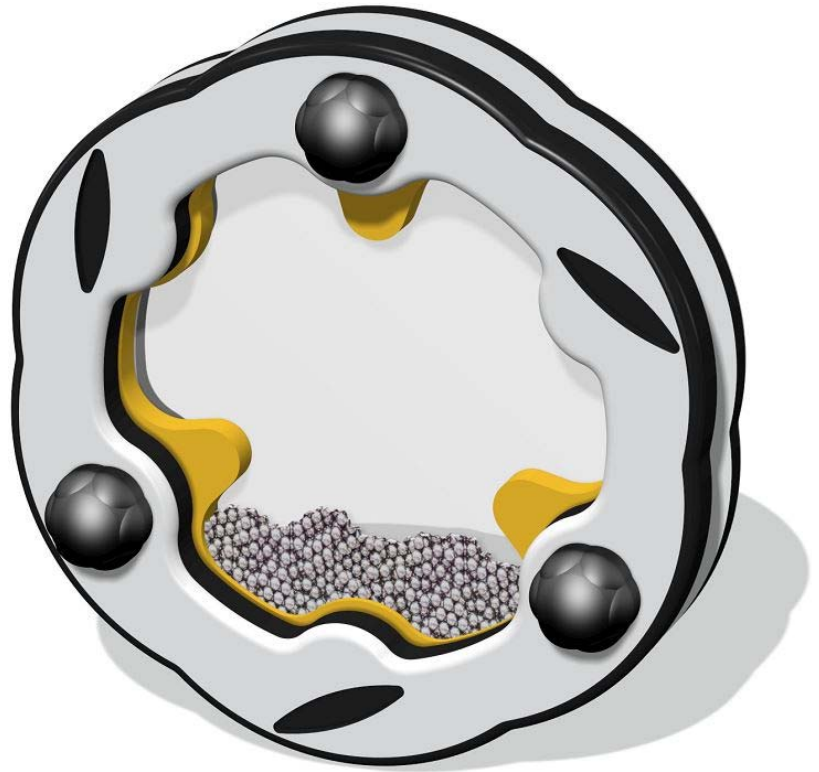

Insert can easily attach to your own panel

DIMENSIONS

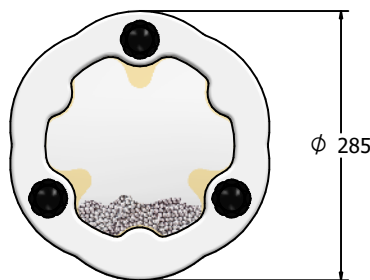
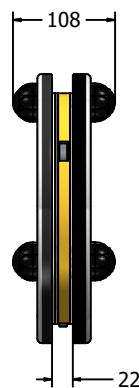
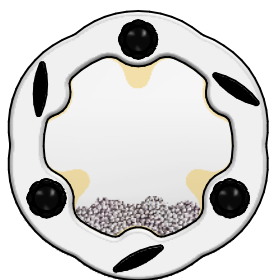

Host Panel Fixing Detail

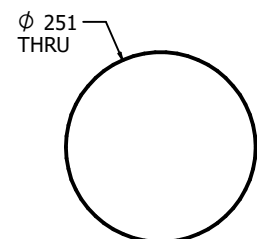

Cutout required in 19mm host panel.

TECHNICAL

Age Range: 2+ Years
 Largest Part: FITUMTSMIN - $\phi 285 \times 108$ mm
 Total Weight: FITUMTSMIN - 3kg Approx.
 Surfacing: N/A

IMPORTANT: you must specify the colour option you require at the time of order if it is different from the colour listed/shown above, requirements are subject to availability at the time of order