



SAMPLE PARK 14 SPLASH PAD PROPOSAL

Nirbo Aquatic Inc.

January, 2016





Sample Park 14 Splash Pad (Rendering 1) | 19001-14-Revision 01





Sample Park 14 Splash Pad (Rendering 2) | 19001-14-Revision 01





Sample Park 14 Splash Pad (Rendering 3) | 19001-14-Revision 01



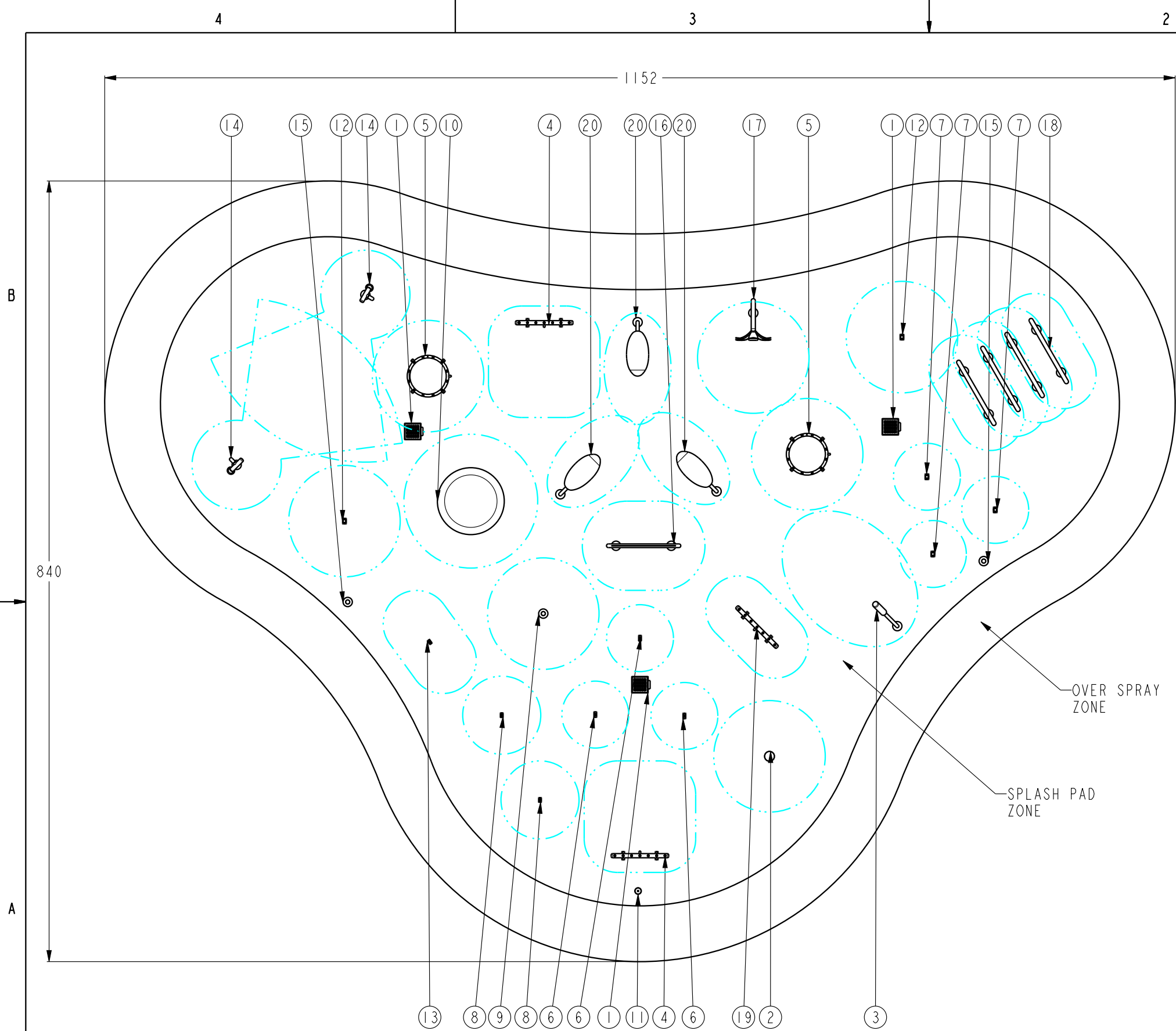

NOTES:

- 1- THIS DOCUMENT IS CREATED FOR REFERENCE PURPOSES ONLY. IT IS NOT CREATED FOR CONSTRUCTION PURPOSES.
- 2- OVER SPRAY ZONE: 5'-10' (CONSIDER NOZZLE DIRECTION, HEIGHT AND WIND CONDITIONS).
- 3- OVER SPRAY ZONE SHALL BE GRADED TO PROVIDE DRAINAGE TOWARDS SPLASH PAD.
- 4- SURROUNDING LANDSCAPE SHALL BE GRADED TO PROVIDE DRAINAGE AWAY FROM SPLASH PAD.
- 5- NIRBO RECOMMENDS 2%-5% GRADING FOR WATER PARK SURFACE TO PROVIDE PROPER DRAINAGE TO DRAINS.
- 6- RECOMMENDED LIGHT BROOM CONCRETE FINISH TO INCREASE SLIP RESISTANCE.
- 7- REFER TO THE INSTALLATION DETAILS OF EACH PRODUCT FOR SPECIFIC INSTALLATION DETAILS.
- 8- ALL COMPONENTS SHALL BE BONDED PER YOUR LOCAL ELECTRICAL CODES.
- 9- ALL PIPING BETWEEN WATER FEATURES & MANIFOLD RECOMMENDED TO BE SCH. 80 PVC.

ITEM	QTY	PART NO	DESCRIPTION	FLOW (GPM)	EXTENDED FLOW (GPM)
1	3	01074-02-D02	DRAIN, 18", 6" OR 8" OUT	0	0
2	1	03022-02-D02	KIDDY PARASOL	8	8
3	1	03062-02-D02	CAT TAIL	20	20
4	2	03124-01-D02	SEVEN LIQUID ARCHES	18	36
5	2	03130-01-D02	LIQUID JAIL	30	60
6	3	03133-01-D02	LIQUID CONE	8	24
7	3	03141-01-D02	GROUND SPRAY	10	30
8	2	03144-01-D02	GROUND MISTER	8	16
9	1	03152-02-D02	WATER DOME	20	20
10	1	03154-02-D02	UMBRELLA 72" DIA	100	100
11	1	03166-01-D02	STEP-ON ACTIVATOR	0	0
12	2	03167-01-D02	LIQUID SPROUT	8	16
13	1	03217-01-D02	WATER FAN	10	10
14	2	03260-02-D02	BLASTER DOUBLE AXIS	10	20
15	2	03268-02-D02	ACTIVATOR-02	0	0
16	1	03306-02-D02	FROG-02	12	12
17	1	03493-02-D02	SINGLE LILY	15	15
18	1	03513-02-D02	FOUR LOOPS	45	45
19	1	03574-01-D02	SEVEN WATER UP	18	18
20	3	03765-02-D02	LEAF	10	30
TOTAL FLOW					480

- NOTES:
- 1- TOTAL AREA INCLUDING OVER SPRAY ZONE: 4657 SQR FT, SPLASH PAD AREA: 3399 SQR FT
 - 2- APPROXIMATE PIPE LENGTH: 3000 FT (ASSUMPTION; MANIFOLD 10 FT AWAY FROM SPLASH PAD EDGE)

	ALL INFORMATION CONTAINED IN THIS DOCUMENT IS PROPERTY OF NIRBO AQUATIC INC. AND MAY NOT BE REPRODUCED OR COMMUNICATED WITHOUT PERMISSION IN WRITING FROM NIRBO AQUATIC INC.		DATE (yyyy.mm.dd) 2020.01.28	SPLASH PAD	
	INCH	1/1	DRAWING NO 19001-14-D02	REV 01	