



SAMPLE PARK 20 SPLASH PAD PROPOSAL

by Nirbo Aquatic Inc.

January , 2016





Sample Park 20 Splash Pad (Rendering 1) | 19001-20-Revision 01





Sample Park 20 Splash Pad (Rendering 2) | 19001-20-Revision 01

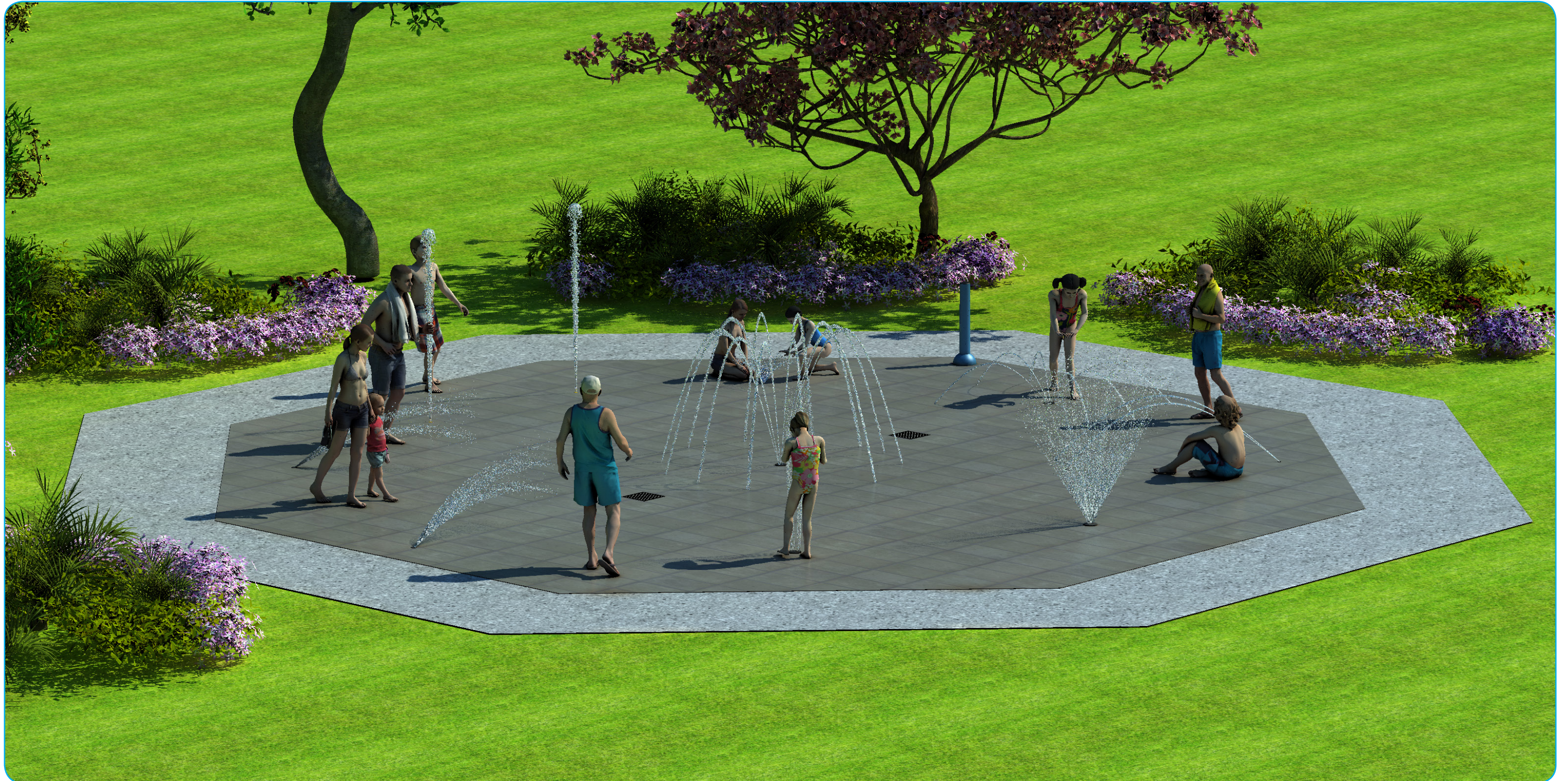



Sample Park 20 Splash Pad (Rendering 3) | 19001-20-Revision 01



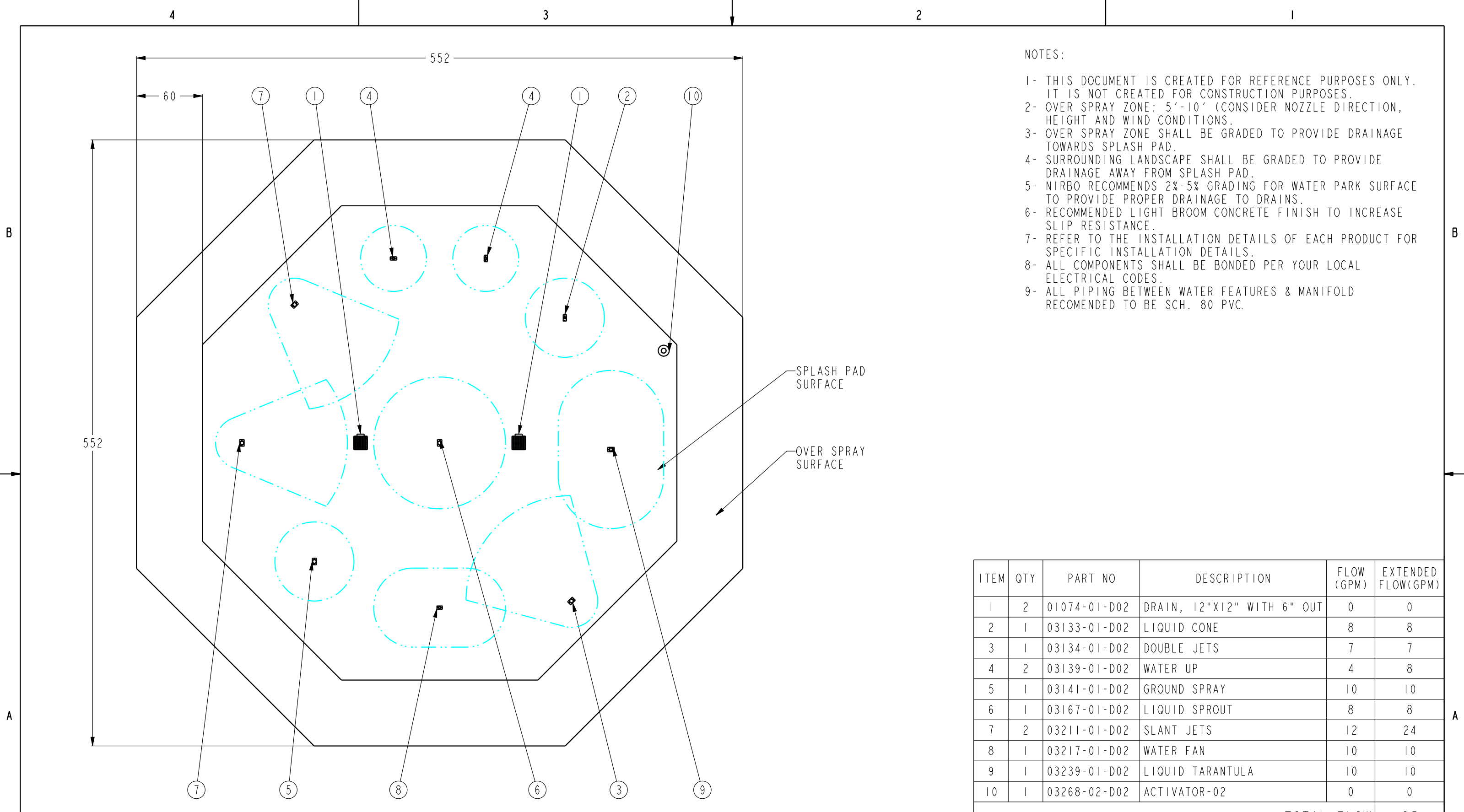

NOTES:

- 1- THIS DOCUMENT IS CREATED FOR REFERENCE PURPOSES ONLY. IT IS NOT CREATED FOR CONSTRUCTION PURPOSES.
- 2- OVER SPRAY ZONE: 5'-10' (CONSIDER NOZZLE DIRECTION, HEIGHT AND WIND CONDITIONS).
- 3- OVER SPRAY ZONE SHALL BE GRADED TO PROVIDE DRAINAGE TOWARDS SPLASH PAD.
- 4- SURROUNDING LANDSCAPE SHALL BE GRADED TO PROVIDE DRAINAGE AWAY FROM SPLASH PAD.
- 5- NIRBO RECOMMENDS 2%-5% GRADING FOR WATER PARK SURFACE TO PROVIDE PROPER DRAINAGE TO DRAINS.
- 6- RECOMMENDED LIGHT BROOM CONCRETE FINISH TO INCREASE SLIP RESISTANCE.
- 7- REFER TO THE INSTALLATION DETAILS OF EACH PRODUCT FOR SPECIFIC INSTALLATION DETAILS.
- 8- ALL COMPONENTS SHALL BE BONDED PER YOUR LOCAL ELECTRICAL CODES.
- 9- ALL PIPING BETWEEN WATER FEATURES & MANIFOLD RECOMMENDED TO BE SCH. 80 PVC.

SPLASH PAD SURFACE

OVER SPRAY SURFACE

ITEM	QTY	PART NO	DESCRIPTION	FLOW (GPM)	EXTENDED FLOW (GPM)
1	2	01074-01-D02	DRAIN, 12"X12" WITH 6" OUT	0	0
2	1	03133-01-D02	LIQUID CONE	8	8
3	1	03134-01-D02	DOUBLE JETS	7	7
4	2	03139-01-D02	WATER UP	4	8
5	1	03141-01-D02	GROUND SPRAY	10	10
6	1	03167-01-D02	LIQUID SPROUT	8	8
7	2	03211-01-D02	SLANT JETS	12	24
8	1	03217-01-D02	WATER FAN	10	10
9	1	03239-01-D02	LIQUID TARANTULA	10	10
10	1	03268-02-D02	ACTIVATOR-02	0	0
TOTAL FLOW					85

SCALE 1:80

- NOTES:
- 1- TOTAL AREA INCLUDING OVER SPRAY ZONE: 1753 SQR FT, SPLASH PAD AREA: 1074 SQR FT
 - 2- APPROXIMATE PIPE LENGTH: 600 FT (ASSUMPTION; MANIFOLD 10 FT AWAY FROM SPLASH PAD EDGE)

NIRBO AQUATIC INC. 	ALL INFORMATION CONTAINED IN THIS DOCUMENT IS PROPERTY OF NIRBO AQUATIC INC. AND MAY NOT BE REPRODUCED OR COMMUNICATED WITHOUT PERMISSION IN WRITING FROM NIRBO AQUATIC INC.		DATE (yyyy.mm.dd) 2020.01.28	WATER PARK		
	UNIT INCH	SHEET 1/1	DRAWING NO 19001-20-D02	REV 01		